



1/4" PHONE CONNECTORS

Amphenol has introduced two ranges of 1/4" Phone plug connectors to satisfy the needs of the manufacturer and the end user. The PRO – a heavy duty on-road plug and the MUSICIAN - a solid performing general use plug. Both series offer different features and benefits and the most suitable type will be determined by application, budget and personal choice. The 1/4" Phone plug jacks range has been widened with the stackable (piggy back) OEM series, saving board space and manufacturing costs. The RCA and Banana plugs complete our extensive range of entertainment interconnects.

Applications

- Audio Cables and Snakes
- Amplifiers
- Speakers
- Mixing desks
- Rack mount equipment
- Patch panels

Features / Options – PRO RANGE 1/4" Phone Plug T-Series.

- Mono or Stereo (TRS)
- Stylised shell design with Ergonomic grip
- Silver or Gold contact plating
- Keyed Shell
- Optional heavy duty metal backshell / boot
- Great solderability
- Increased solder area on ground contact
- "Jaws" Cable Clamp
- Precision machined contacts

Features / Options – MUSICIAN RANGE 1/4" Phone Plug

- Mono or Stereo (TRS)
- Compact Shell
- Straight or Right angle
- Stylish shell design
- Flexible grommet cable protection
- Silver or Gold contact plating
- Satin, Nickel or Black finish
- Machined or Diecast shell

Features / Options – OEM RANGE 1/4" Phone Jack

- Mono or Stereo (TRS)
- Stackable (Piggy back) mounting
- Vertical or Horizontal PCB mount
- Mono and Stereo switched contacts
- Solder contacts
- Combo contacts
- Metal nut
- Plastic nut

Features / Options – RCA Plug

- Female or Male
- Red or Black strip for channel I.D.
- Gold plated finish
- Gold plated contacts

Features / Options – Banana Plug

- Red or Black for channel I.D.
- Gold or Nickel plated contacts

Jaws Cable Clamp Options for T-Series



Standard Jaws cable clamp (Black), Cable O.D 3mm to 6mm (0.118" to 0.236")



Large Jaws cable clamp (Purple), Cable O.D 6mm to 7.5mm (0.236" to 0.295")

Ordering Codes

We have listed the more common ordering codes in each section. Please contact us if you need any further assistance.

Simple steps to guide you in using this catalogue

- 1) Identify the product group listed in Contents on Page 1 and go directly to that page number.
- 2) Each product group cover page then details information and options available.
- 3) Refer to the product detail pages and identify the product you require pictorially.
- 4) Read the product description column for the products standard features.
- 5) Use variations column to determine your choice.
- 6) Identify part number.
- 7) In the event the particular option you require is not listed please refer to the part number breakdown page at the end of each section.
- 8) Please contact us directly if you have any further problems.



Amphenol



1/4" PHONE PLUGS

T-SERIES (PRO RANGE)



Features:





- Mono or Stereo (TRS).
- Stylised shell design with Ergonomic grip.
- Robust diecast shell in Satin nickel or Black finish.
- Silver or Gold contact plating.
- Keyed shell.
- Optional heavy duty metal backshell / boot.
- Great solderability.
- Increased solder area on ground contact.
- "Jaws" Cable Clamp.
- Precision machined contacts.
- Quick and easy assembly.

Options: Gold Contacts, Large or Small Jaws Cable Clamp, Black Shell, Metal Backshell / Boot, Bulk Pack.

Part Number Breakdown: Page 70 **Specifications:** Page 71

PRODUCT - FIGURE	DRAWING	DESCRIPTION	VARIATIONS	PART NUMBER
		1/4" (6.35mm \varnothing) Mono Phone plug, Jaws cable clamp, Thermoplastic backshell, Satin finish.	Standard Gold Plated Contacts Large Cable Clamp Bulk Pack	TM2P TM2P-AU TM2PJ TM2P BULK
		1/4" (6.35mm \varnothing) Mono Phone plug, Jaws cable clamp, Thermoplastic backshell, Black finish.	Standard Gold Plated Contacts Large Cable Clamp Bulk Pack	TM2PB TM2PB-AU TM2PBJ TM2PB BULK
		1/4" (6.35mm \varnothing) Stereo Phone plug, Jaws cable clamp, Thermoplastic backshell, Satin finish.	Standard Gold Plated Contacts Large Cable Clamp Bulk Pack	TS3P TS3P-AU TS3PJ TS3P BULK
		1/4" (6.35mm \varnothing) Stereo Phone plug, Jaws cable clamp, Thermoplastic backshell, Black finish.	Standard Gold Plated Contacts Large Cable Clamp Bulk Pack	TS3PB TS3PB-AU TS3PBJ TS3PB BULK



PRODUCT - FIGURE	DRAWING	DESCRIPTION	VARIATIONS	PART NUMBER
		<p>1/4" (6.35mmø) Mono Phone plug, Jaws cable clamp, Metal backshell, Satin finish.</p>	Standard	TM2PN
			Gold Plated Contacts	TM2PN-AU
			Large Cable Clamp	TM2PNJ
			Bulk Pack	TM2PN BULK
		<p>1/4" (6.35mmø) Mono Phone plug, Jaws cable clamp, Metal backshell, Black finish.</p>	Standard	TM2PBM
			Gold Plated Contacts	TM2PBM-AU
			Large Cable Clamp	TM2PBMJ
			Bulk Pack	TM2PBM BULK
		<p>1/4" (6.35mmø) Stereo Phone plug, Jaws cable clamp, Metal backshell, Satin finish.</p>	Standard	TS3PN
			Gold Plated Contacts	TS3PN-AU
			Large Cable Clamp	TS3PNJ
			Bulk Pack	TS3PN BULK
		<p>1/4" (6.35mmø) Stereo Phone plug, Jaws cable clamp, Metal backshell, Black finish.</p>	Standard	TS3PBM
			Gold Plated Contacts	TS3PBM-AU
			Large Cable Clamp	TS3PBMJ
			Bulk Pack	TS3PBM BULK
		<p>1/4" (6.35mmø) Phone plug, Jaws cable clamp, Black Metal backshell, Satin finish shell.</p>	Mono (Std. Clamp)	TM2PM
			Mono (Large Clamp)	TM2PMJ
			Stereo (Std. Clamp)	TS3PM
			Stereo (Large Clamp)	TS3PMJ



PART NUMBER BREAKDOWN

T-SERIES (PRO RANGE)

E. G. **TS3PBMJ-AU BULK**
T (Series Prefix), **S3**(Stereo), **Plug Black**, **Metal Nut (Black)**, **J** (Large Jaws),
- AU (Gold Plated Contacts), **Bulk** Packaged.

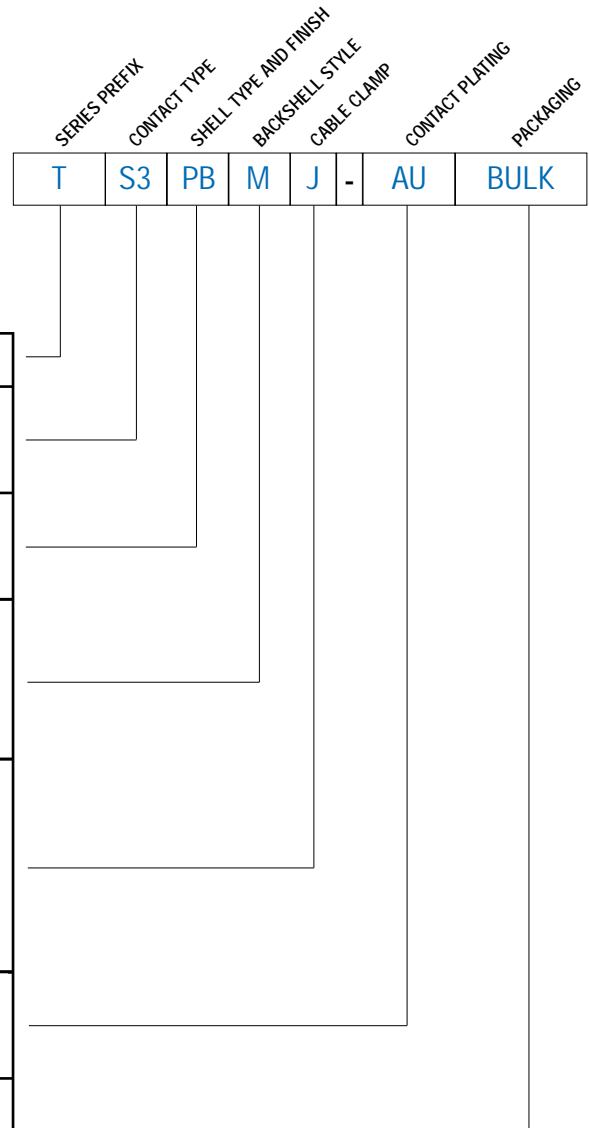

SERIES PREFIX	T	=	Series Prefix
CONTACT TYPE	M2	=	2 Pole (mono)
	S3	=	3 Pole, tip/ring/sleeve (stereo)
SHELL TYPE AND FINISH	P	=	Plug Satin Nickel
	PB	=	Plug Matt Black
BACKSHELL TYPE	Blank	=	Plastic Nut
	M	=	Metal Nut - Black
	N	=	Metal Nut - Satin Nickel
CABLE CLAMP	Blank	=	Standard Jaws 3mm to 6mm Cable O.D. (0.118"Ø to 0.236"Ø)
	J	=	Large Jaws 6mm to 7.5mm Cable O.D.(0.236"Ø to 0.295"Ø)
CONTACT PLATING	Blank	=	Silver Plated Contacts (Standard)
	AU	=	Gold Plated Contacts
PACKAGING	Blank	=	Individual Bags
	BULK	=	Bulk Packed

ISO VIEW OF TM2P

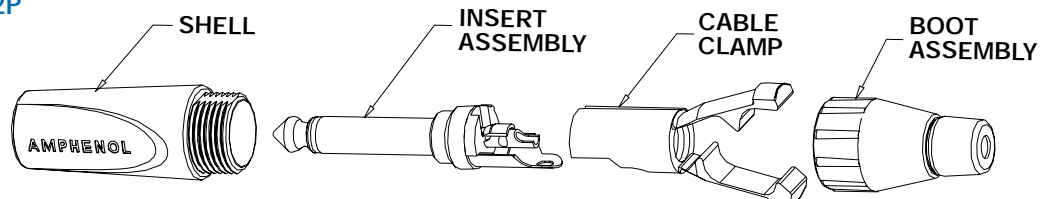

1/4" PHONE PLUG TECHNICAL DATA

		VALUE
GENERAL CHARACTERISTICS	Number of Contacts	2 Pole (Mono) 3 Pole Tip Ring Sleeve (Stereo)
	Termination	Solder
	Max. Wire Gauge - Stranded Wire	2 Pole (Mono): AWG 16-1.5mm ² 3 Pole (Stereo): AWG 18-1mm ²
	Flammability rating of insulating plastics	UL94V-0
	Solderability, complies with	IEC 68-2-20
ELECTRICAL CHARACTERISTICS	Current Carrying Capacity	10A (Depends on Mating Connector and Cable)
	Typical Contact Resistance	Depends on Mating Connector
	Insulation resistance (initial)	>2GΩ
	After Damp Heat Test	≥ 1GΩ
	Dielectric Withstand Voltage	2 Pole : 1.5 kV dc 3 Pole : 1 kV dc
CLIMATIC CHARACTERISTICS	Protection Class	IP40
	Operating Temperature	-25°C to +75°C (-13°F to + 167°F)
MECHANICAL CHARACTERISTICS	Insertion and Withdrawal Force	≥ 10N - ≤ 30N
	Weight ¹⁾ Thermoplastic Backshell	28g (0.061lb)
	Weight ¹⁾ Metal Backshell	35g (0.077lb)
	Typical Cable Retention Force	22kg to 44kg (50lb to 100lb) - Dependent on cable material and diameter.
	Cable O.D. - Standard Jaw	3mm to 6mm (0.118" to 0.236")
Cable O.D. - Large Jaw	6mm to 7.5mm (0.236" to 0.295")	
MATERIALS	Connector Shell Material	Diecast Zinc Alloy EZDA No.3
	Shell Finish	Satin Nickel or Black Polyester
	Insulators	UL94 V-0 PBT Resin or Modified PPE Resin - Black
	Boot / Backshell	UL94 V-0 PBT Resin or Modified PPE Resin - Black or Metal CuZn ³⁹ Pb ³
	Finish	Satin Nickel or Black
	Cable Clamp	UL94 V-0 PBT Modified PPO Resin - Black
	Cable Bushing	Thermoplastic Polyurethane
	Contacts / Plating	Brass /Ag or Au over 2µm Ni

Rev 1 - 08/2003

¹⁾ Approximate weight only, does not include packaging. Please contact us for exact weight for shipping purposes.





Features:

- Mono or Stereo (TRS).
- Stylish shell design.
- Robust diecast shell in Satin nickel or Black finish.
- Silver or Gold contact plating.
- Flexible grommet cable protection.
- Improved solderability.
- Precision machined contacts.
- Convenient bulk packaging as standard.

Options: Black Shell, Gold contacts.

PRODUCT - FIGURE	DRAWING Dimensions in mm (inches)	DESCRIPTION	VARIATIONS	PART NUMBER
		1/4" (6.35mmø) Mono Phone plug, Diecast Shell, Satin finish, Flexible grommet. (Supplied in Bulk pack of 100 only)	Standard Gold Plated Contacts	ACPM-GN BULK ACPM-GN-AU BULK
		1/4" (6.35mmø) Mono Phone plug, Diecast Shell, Black finish, Flexible grommet. (Supplied in Bulk pack of 100 only)	Standard Gold Plated Contacts	ACPM-GB BULK ACPM-GB-AU BULK
		1/4" (6.35mmø) Stereo Phone plug, Diecast Shell, Satin finish, Flexible grommet. (Supplied in Bulk pack of 100 only)	Standard Gold Plated Contacts	ACPS-GN BULK ACPS-GN-AU BULK
		1/4" (6.35mmø) Stereo Phone plug, Diecast Shell, Black finish, Flexible grommet. (Supplied in Bulk pack of 100 only)	Standard Gold Plated Contacts	ACPS-GB BULK ACPS-GB-AU BULK
		1/4" (6.35mmø) Phone plug, Right Angle, Machined shell, Nickel finish	Mono Stereo	ACPM - MRN ACPS - MRN
		1/4" (6.35mmø) Phone Jack, Horizontal Snap-fit PCB, Plastic housing, Metal nut and entry bore	Mono Stereo	ACJM - MHDR ACJS - MHDR



PRODUCT - FIGURE	DRAWING	DESCRIPTION	TYPE	PART NUMBER
		1/4" (6.35mmø) Dual Phone Jack (Piggyback) Horizontal Snap-fit PCB, Plastic housing, Metal nut and entry bore	Mono	ACJM - MHD
			Stereo	ACJS - MHD
		1/4" (6.35mmø) Jack, Horizontal PCB mount, Plastic housing with metal insert	Mono - Plastic Nut	ACJM - PH
			Mono - Metal Nut	ACJM - MH
		1/4" (6.35mmø) Jack, Horizontal PCB mount, Plastic housing with metal insert	Stereo - Plastic Nut	ACJS - PH
			Stereo - Metal Nut	ACJS - MH
		1/4" (6.35mmø) Jack, Horizontal Snap-fit PCB mount, Plastic housing with metal insert	Mono - Plastic Nut	ACJM-PHR
			Mono - Metal Nut	ACJM-MHR
			Stereo - Plastic Nut	ACJS-PHR
			Stereo - Metal Nut	ACJS-MHR
		1/4" (6.35mmø) Jack, Combination Horizontal PCB and Solder lug, Plastic housing with metal insert	Mono - Plastic Nut	ACJM - PC
			Mono - Metal Nut	ACJM - MC
			Stereo - Plastic Nut	ACJS - PC
			Stereo - Metal Nut	ACJS - MC
		1/4" (6.35mmø) Jack, Solder Lug, Plastic housing with metal insert	Mono - Plastic Nut	ACJM-PHS
			Mono - Metal Nut	ACJM-MHS
			Stereo - Plastic Nut	ACJS-PHS
			Stereo - Metal Nut	ACJS-MHS
		1/4" (6.35mmø) Jack, Vertical PCB mount, Needle eye contacts, Star washer, Metal nut and insert	Refer circuit schematic chart page 74	ACJM-MN-2
				ACJS-MN-3
				ACJM-MN-2S
				ACJS-MN-3S
				ACJS-MN-5
		1/4" (6.35mmø) Jack, Vertical PCB mount, Metal nut and insert	Mono	ACJM-MV
			Stereo	ACJS-MV
		1/4" (6.35mmø) Jack, Solder lugs, Metal nut and insert	Mono	ACJM-MS
			Stereo	ACJS-MS



PRODUCT - FIGURE	DRAWING	DESCRIPTION	TYPE	PART NUMBER
		RCA Male plug, Gold finish Max cable O.D 6mm (0.236")	Red	AC-RCAMR-AU
		RCA Male plug, Gold finish Max cable O.D 6mm (0.236")	Black	AC-RCAMB-AU
		RCA Female plug, Gold finish Max cable O.D 6mm (0.236")	Red	AC-RCAFR-AU
		RCA Female plug, Gold finish Max cable O.D 6mm (0.236")	Black	AC-RCAFB-AU
		Banana Plug – Dual, Plastic housing, Nickel plated contacts Max cable O.D 5mm (0.196")	Red	AC-BPD-R
		Banana Plug – Dual, Plastic housing, Nickel plated contacts Max cable O.D 5mm (0.196")	Black	AC-BPD-B
		Banana Plug – Dual, Plastic housing, Gold plated contacts Max cable O.D 5mm (0.196")	Red	AC-BPD-R-AU
		Banana Plug – Dual, Plastic housing, Gold plated contacts Max cable O.D 5mm (0.196")	Black	AC-BPD-B-AU

PANEL CUTOUTS - FRONT VIEW

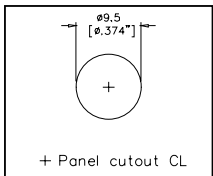

ACJM-MV
ACJS-MV
ACJM-MS
ACJS-MS
ACJM-MN-2
ACJS-MN-3
ACJM-MN-2S
ACJS-MN-3S
ACJM-MN-5

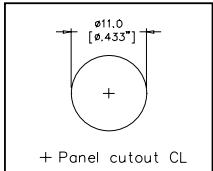

ACJM/S-PH
ACJM/S-MH
ACJM/S-PC
ACJM/S-MC
ACJM/S-PHR
ACJM/S-MHR
ACJM/S-PHS
ACJM/S-MHS

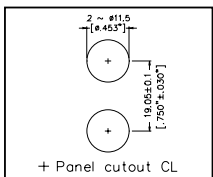

ACJM-MHD
ACJS-MHD

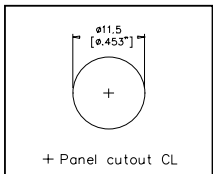

ACJM-MHDR
ACJS-MHDR

PCB FOOTPRINT - CONNECTOR SIDE OF PCB

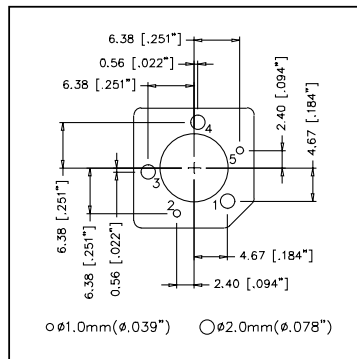

ACJM-MV
ACJS-MV
ACJM-MN-2
ACJS-MN-3
ACJM-MN-2S
ACJS-MN-3S
ACJM-MN-5

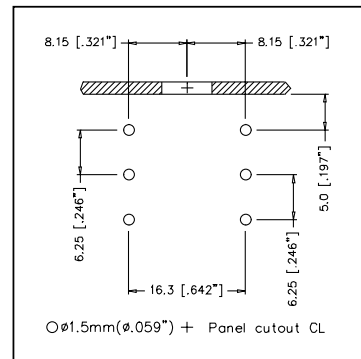

ACJM-PH
ACJM-MH
ACJS-PH
ACJS-MH
ACJM-PC
ACJS-PC
ACJM-MC
ACJS-MC
ACJM-PHR
ACJS-PHR
ACJM-MHR
ACJS-MHR

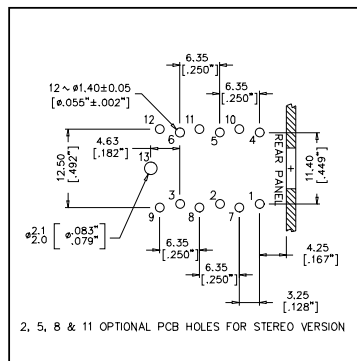

ACJM-MHD
ACJS-MHD

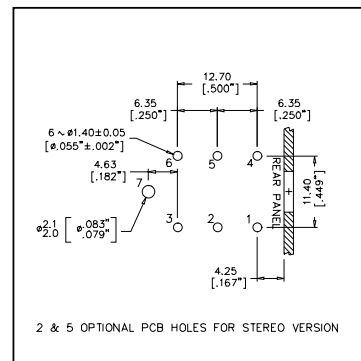

ACJM-MHDR
ACJS-MHDR

SCHEMATIC CHART

PART No.	ACJM-MN-2	ACJM-MN-2S	ACJS-MN-3	ACJS-MN-3S	ACJS-MN-5
SCHEMATIC					